

CELECT

DRT 1

LCD Electronic Thermostat

**CORONADO CONTROLS LTD
BOLTON BL1 2PT**

www.coronadocontrols.com

Instruction Manual

TABLE OF CONTENT

| | |
|--------------------------------|----|
| A. Installation and Mounting | |
| 1. Installation..... | 2 |
| 2. Mounting Instruction..... | 3 |
| 3. Wiring..... | 3 |
| 4. Battery Installation..... | 5 |
| B. Temperature setting up..... | 7 |
| C. Jumper Selection..... | 8 |
| D. Maintenance..... | 9 |
| E. Specification..... | 10 |

E. Specification:

| | |
|-------------------------|------------------------|
| Temperature Range: | 5 to 35°C adjustable |
| Switching Differential: | Approx 0.5°C |
| Power Supply: | 2 x AAA battery |
| Frequency: | 50/60Hz |
| Rating: | 24...250VAC 5(3.5)A |
| Sensing Element: | NTC thermistor |
| Electronic Control: | Type 2.B action |
| Time Constant: | Approx. 2 min |
| Terminals: | 2mm ² Cable |
| Operating Temperature: | 0 to 45°C |
| Storage Temperature: | -10 to 55°C |

1

10

D. Maintenance:

- 1/. No heating or cooling control
- Check "Heater/Cooler" jumper connection, replace the jumper if necessary
 - Check relay on/off performance by applying DC voltage at the coil, if it works then trace the control circuit otherwise replace it
 - Check rubber key performance by pressing ▲ or ▼, the  icon should appear with the temperature setting changes. Otherwise align the rubber key or the LCD connector properly. If the problem is not fixed then replace the PCB
 - Check the thermistor sensor performance by measuring the corresponding variable resistance under different temperature, if it is in good condition and the LCD value will change accordingly, then trace the control circuit or the LCD connection, otherwise replace it
 - If the control circuit has problem, replace the PCB if necessary

9

DRT 1 LCD Electronic Thermostat

A. Installation, Mounting:

Caution:
Switch off the electric source before maintenance the thermostat. We recommend that the maintenance should be performed by trained personnel.

1. Mounting Location:

The thermostat is restricted to indoor use only. It should be mounted on an inner wall about 1.5m above the floor in a position where it is readily affected by the changes of the general room temperature with freely circulating air. Avoid mounting on hot surfaces or in damp areas. Do not expose to direct sunlight.

2

2. Mounting the thermostat:

- Ensure the surface is level
- Place cables through aperture near terminal block
- Insert 2 wall anchors into pre-drilled holes in walls
- Fasten the thermostat to the wall with 2 long screws through the mounting holes

3. Wiring:

- Wire the correct cables to the terminal block according to the circuit diagram which is attached inside the thermostat top cover
- Push all cables back into wall prior to fixing to avoid trapping wires
- It is recommended that a 5A fuse is fitted.

3

C. Jumper Selection:

- Heating, Cooling Jumper Bridge.
When the jumper bridge is connected to "Heater" heating function is selected. When jumper bridge is connected to "Cooling" cooling function is selected. If there is no jumper connection selected then the thermostat will not operate.

8

B. Temperature setting:

- Select the comfortable temperature by pressing ▲ or ▼ to the desirable temperature
- Room temperature display will resume after 8 seconds with the  icon disappears

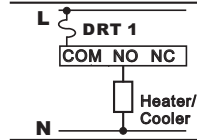
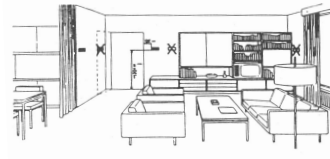

7

4

4. Install or replace the battery:

Caution: Turn off the electrical devices and disconnect the supply to the appliances before replacing the batteries. Replace only with the same or equivalent type of batteries. Do not dispose the used batteries with the household waste. Refer to your local area for the proper disposal.

1. Pull out the battery drawer .
2. Place the new batteries according to the marking on the battery drawer.
3. Dispose the old batteries properly.
4. Slide the battery drawer back to its position.
5. Check if the thermostat works properly or not. Press "Reset" if necessary.

DRT 1 Installation

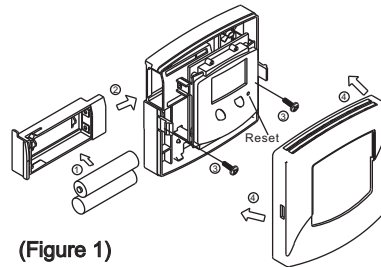

(Figure 1)

5

6