

# Instruction Manual

Model: TH-7281H / 7281HS

## Electronic Thermostat



### Wiring Diagram: TH-7281HS

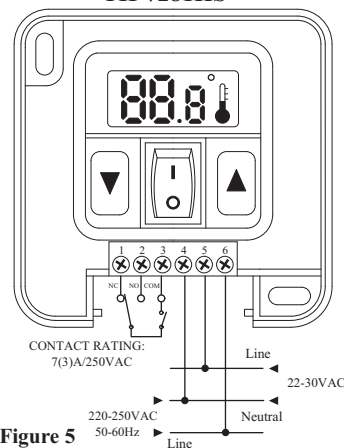
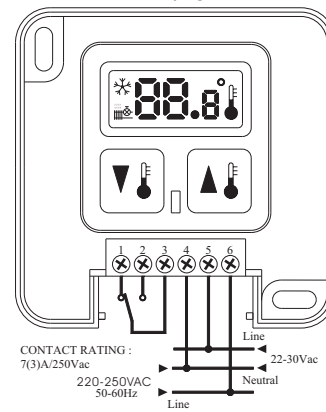

Figure 5

### TH-7281H



## Installation

1. Look for a location, which has a constant temperature in the house and it, is not near the door entry or air condition outlet (see example on Figure 1).

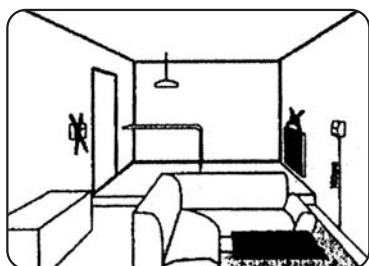

Figure 1

2. Warning!! Must remember to turn off your main power switch before installation the thermostat.

3. Disconnecting the front cover by using a screwdriver pressing a hook on the top of the front cover.(see Figure 2). Pull the front cover out with your hand holding on two sides of the cover (see Figure 3).

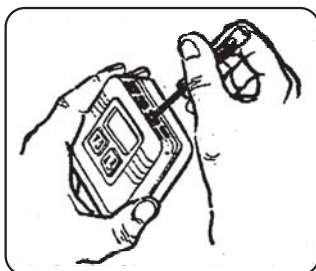

Figure 2

4. Mount the base with the wire through the hole of the base and mount the base with screwdriver on the wall.

5. Install the wires into the terminal block with a screwdriver to tighten the screw top of terminal block (see figure 4). Before wiring, you MUST check your system-wiring diagram. If your system is other than this type, please consult with your local dealer or a profession electrician.

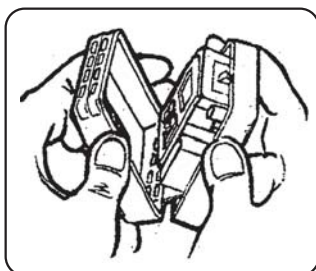

Figure 3

6. Cover the front cover back to the base and make sure the hooks on the base are locked with front cover.

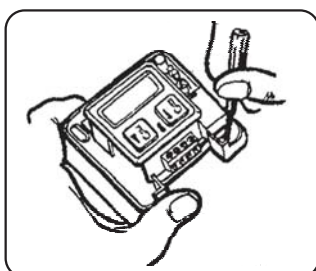

Figure 4

7. You can turn on the main power switch for operation.

### Key Function:



TH-7281HS

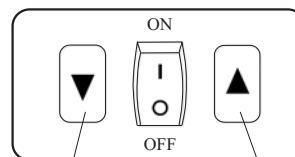

Temperatures DOWN

Temperatures UP



TH-7281H

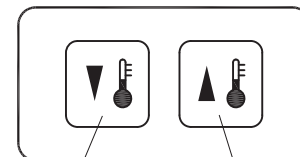

Temperatures DOWN

Temperatures UP

### Setting and Operation

1. Press either ▲ or ▼ and LCD display will appear a flashing temperature with “Temperature Set” symbol (7281H/7281HS) and “Heat On” symbol (7281H)\* or “A/C On” symbol (7281H)\*
2. Press again either ▲ or ▼ to set a desired temperature. Every press on ▲ will increase 1°C and every press on ▼ will decrease 1°C.
3. When you complete setting your desired temperature, please wait for 15 seconds until the LCD display stops flashing and then the thermostat starts to operate. When the room temperature reaches your desired setting, the unit will function to maintain the set temperature.
4. **For 7281H ONLY:**  
When the thermostat is operating, the LCD displays room temperature with “Heat On” symbol (☀️)\* or “A/C On” symbol (❄️)\*, and the LED lamp between ▲ and ▼ on the front panel will be on.
5. **For 7281HS ONLY:**  
Pressing ON/OFF switch to set the thermostat in operation mode (Symbol: I) or in stand by mode (Symbol: O). When in operation mode, the thermostat will enable the central heating system or the air conditioning system automatically, if it is in stand by mode, the thermostat will not enable any device.

\* Depends on your thermostat. If your unit is for central heating controlling, the “A/C On” symbol will not appear at any time. If it is for an air condition system, the “Heat On” symbol will not appear at any time.