

## CC816WHB-0-DF Radio controlled thermostat

CC816WHB-0-DF is a radio controlled room thermostat which requires no wiring and can be fitted in any normal operating environment within an open area 100 meter range of the CC2010-DE receiver.

If the thermostat and the receiver have been supplied together in a combined pack, the units have been paired in the factory and no commissioning is required.

### SPECIFICATION

Power supply .....	2AA Batteries
Radio communication mode .....	Half-duplex
Frequency band .....	868MHZ ( FSK )
Valid receiving distance .....	100m
Accuracy.....	±1°C
Room temperature setting range.....	5°C~30°C
Ambient temperature -Operation .....	0°C~+50°C
Ambient temperature –transport .....	-10°C~60°C
Dimension .....	86x86x32mm ( wall mount or 86 box )

### KEYBOARD, DISPLAY AND SWITCH DESCRIPTION

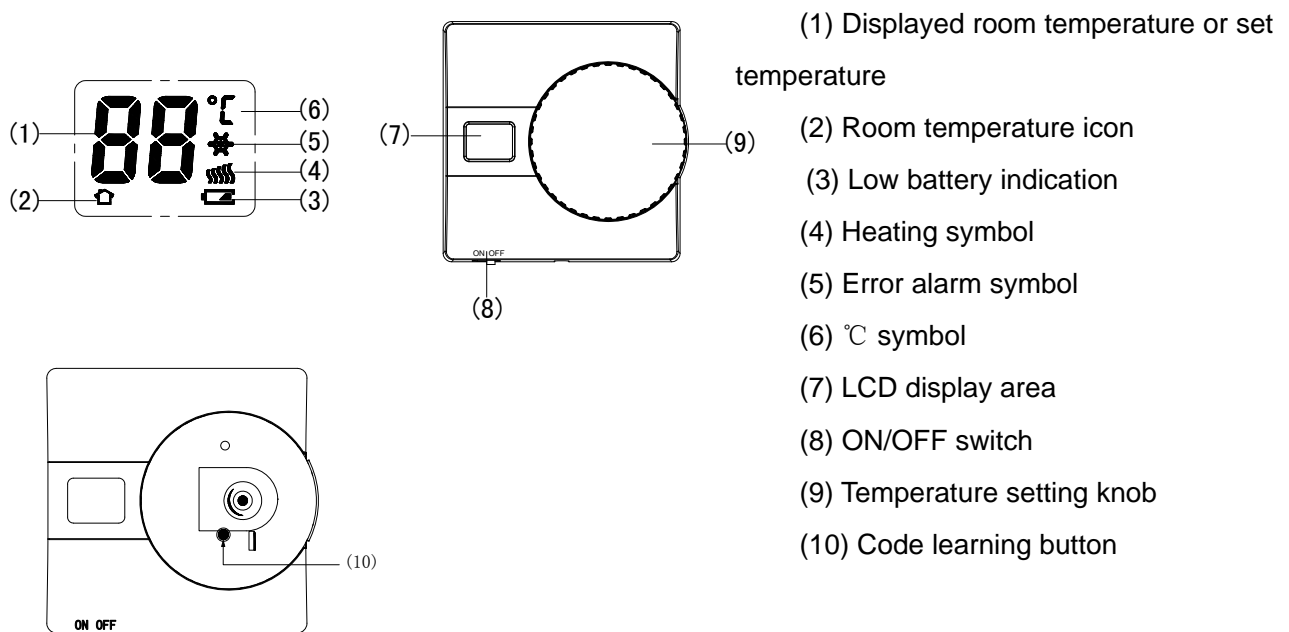

### IMPORTANT SAFETY INFORMATION:

- Always turn off power at the main power source by unscrewing fuse or switching circuit breaker to



the off position before installing, removing, cleaning, or servicing this thermostat.

- Read all of the information in this manual before installing this thermostat.
- Only a professional contractor should install this thermostat.
- All wiring must conform to local and national building and electrical codes and ordinances.
- This thermostat has a removable fuse to protect the system from damage. If system is not operating properly, check wiring and replace fuse if necessary.
- Use this thermostat only as described in this manual.

### MOUNTING AND WIRING DIAGRAM

1. Remove assembly screws from the base of thermostat. Gently pull the upper housing straight off the base. Forcing or prying on the thermostat will cause damage to the unit. See figure 1-2.
2. Install two fresh “AA” alkaline batteries in battery compartment. Be sure to match positive (+) ends of batteries with positive (+) battery terminals in the battery compartment. See figure 3. (Note: the product long time not use it, please take out the battery, prevent the battery fluid leakage, damaged products.)
3. Push power base into wall.
4. Using mounting screws mount the power base to the wall. Place a level against bottom of base, adjust until level, and then tighten screws. (Leveling is for appearance only and will not affect thermostat operation.)
5. Replace the upper housing on the base and fix the upper housing by removed assembly screw.

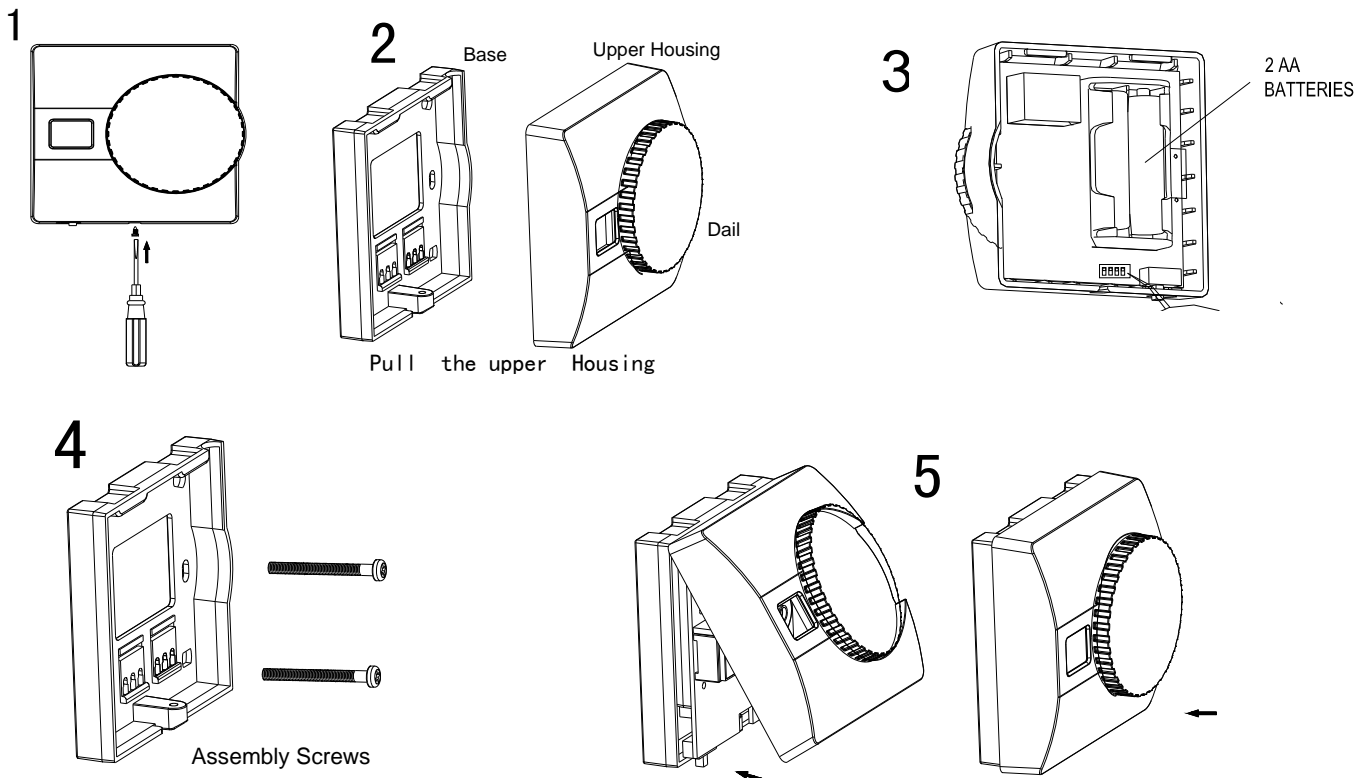

---

## OPERATION

### Commissioning

No commissioning is required when the thermostat and the receiver have been supplied in the combined pack because they have been paired in the factory. User can make commissioning again by following steps for any possible reason.

STEP 1: Wire the SAS2010DE receiver, switch off the receiver and hold the power button for 3 seconds until the yellow light is on.

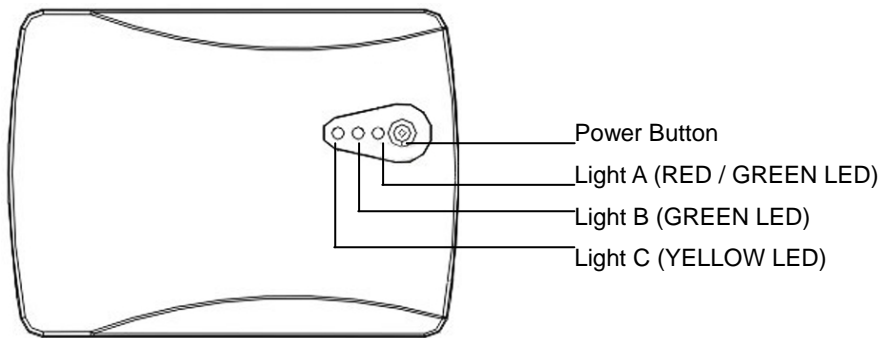

STEP 2: Rotate the setting knob of the RF thermostat till 5 °C shows in the display.

STEP 3: Remove the dial, press and hold the LEARN button for 3 seconds. When the yellow light flashes in the receiver and thermostat's display shows 01, the thermostat and the receiver have successfully been paired.

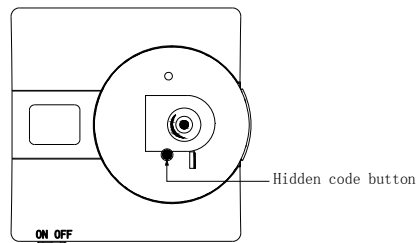

**Rotary disk installation diagram:**

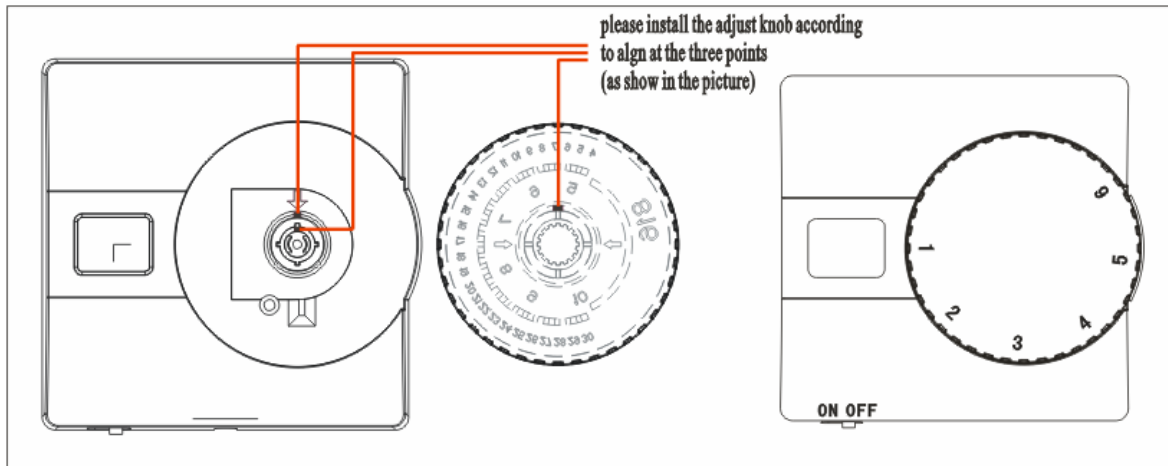

### Display

The LCD displays actual room temperature until the setting dial is moved.

### Setting the temperature

Switch on the thermostat , turn setting dial to required temperature. The selected temperature will flash in the LCD to signify it is showing the set temperature. After a short period the display stops flashing and shows actual room temperature.

### Heating mode

A heating symbol  will be lit whenever the thermostat is calling for heat and a “Heat on” requirement signal will send to the receiver. The receiver will turn on the heating when there is no error in communication.

The heating symbol  will disappear when the room temperature reaches the set points and a “Heat off” signal will send to the receiver. The receiver will turn off the heating when there is no error in communication.

The thermostat’s display shows Er2 will show in the display when there is error in communication between the receiver and the thermostat.

### Low battery indication

A battery symbol  will flash in the display when batteries require replacement. Batteries should be replaced within 15 days, after which the thermostat will turn off the load it is controlling. When this happens “OF” will be displayed.

### Error Code

**E1** flashing in the display: Room sensor short circuit. Thermostat shut down all output

**E2** flashing in the display: Room sensor broken. Thermostat shut down all output.

Er2 flashing in the display: Communication error between thermostat and receiver.



---

### **CUSTOMER ASSISTANCE**

After reading this guide, if you have any question about the operation of your thermostat, please contact your installer or Energy Utility company or service provider.