

Wireless Thermostat CCRC30F-KIT

OWNER'S MANUAL

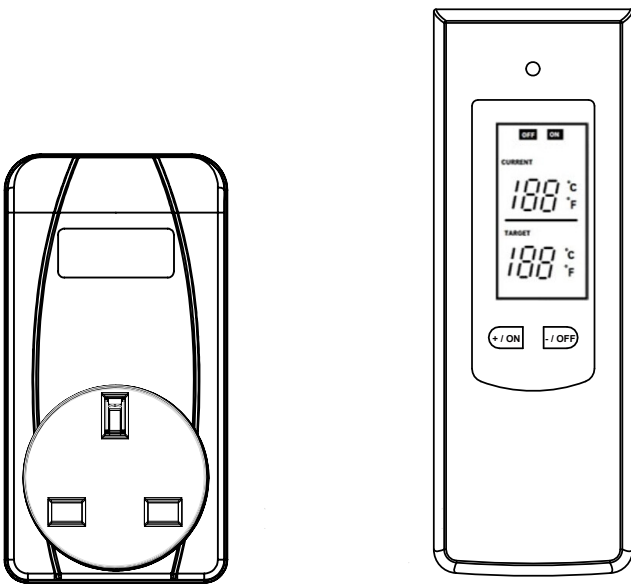

CCRC30F-KIT

FEATURES:

- ◆ Current Temperature
- ◆ Target Temperature
- ◆ Automatic ON/OFF
- ◆ Always ON/OFF
- ◆ °C/°F Switchable
- ◆ Low Battery Warning
- ◆ Low Temperature Warning
- ◆ High Temperature Warning
- ◆ Memory Settings
- ◆ Room Thermostat
- ◆ 433 Mhz RF technology
- ◆ Multi-Channels
- ◆ 13A,3250W
- ◆ 250V,50HZ

1. INTRODUCTION

Congratulations on your purchase of this Wireless Thermostat, CCRC30F-KIT

Please take the time to read and understand this manual so you can begin to enjoy the convenience and features this product brings to you.

The wireless thermostat is suitable for many kinds of heating device and protect some home appliances.

It will automatically turn on/off heating device as the ambient temperature changing, in order to maintain a constant room temperature.

2. DESCRIPTION

- 1 Green LED indicator
- 2 LCD part: Display wireless thermostat ON or OFF status
- 3 LCD part: Display the CURRENT temperature in °C/°F
- 4 LCD part: Display the TARGET temperature in °C/°F
- 5 LEFT button: + / ON, Set the target temperature/Always ON
- 6 RIGHT button: - / OFF, Set the target temperature/Always OFF

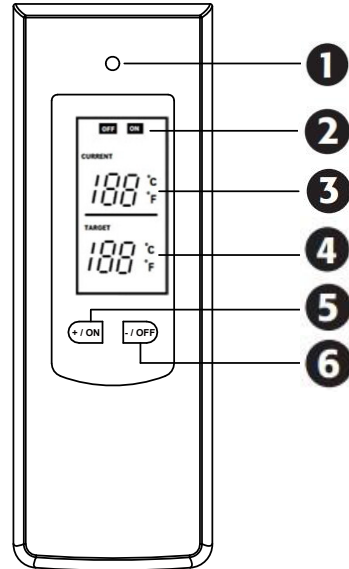

* °C/°F Switchable:
Hold and press 5 & 6 at the same time about 3 seconds, then it will switch between °C/°F

3. DESCRIPTION

- 7 Red LED indicator and LOGO Label
- 8 The child protection Plug, UK Type
- 9 Rating Label
- 10 The child protection Socket, UK Type

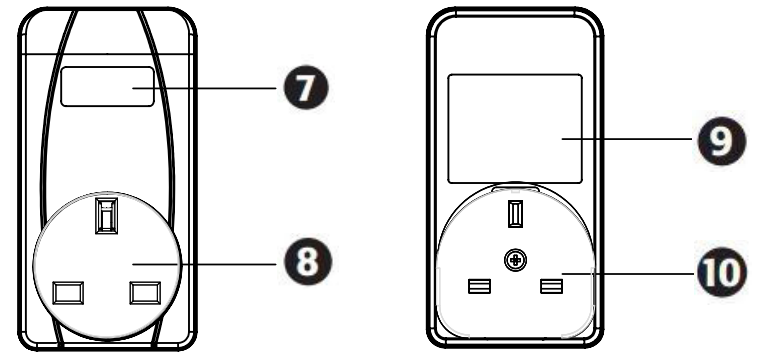

4. AUTO CODING

Thermostat control is always in transmitting status, when RC30F-PLUG is plugged into home electricity for the first time, the red LED indicator 7 will be flashing, this means it is in auto coding status:

If can't search any transmit signal from thermostat control unit it will flash 2 minutes and then exit the coding progress.

If can search transmit signal, it will be back to normal. It means coding successful.

* **Memory Function:**
All the settings will be memoried even if cut off power It includes code pairing method, target temperature settings.

* **Low Battery Warning:**
This product can be with 2pcs*1.5VAA battery, °C/°F symbol will be flashing when the battery is lower than 2.7V,

5. AUTO OPERATION

Press 5 or 6 to choose the target temperature:

Resolution: ±1°C or ±1°F

* When the TARGET temperature is higher than the CURRENT temperature:

1. In Figure 1, CURRENT(20°C) < TARGET(30°C)
2. The wireless thermostat sends commands to all the sockets to turn ON the connected heating device.
3. LCD display ON symbol
4. The red LED indicator 7 is ON
5. The connected heating device will be in working status to warm the house.

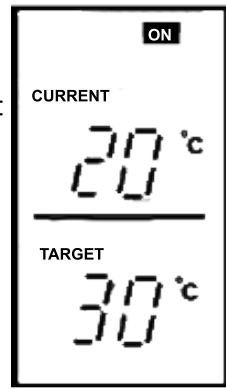

Fig.1

6. AUTO OPERATION

As the heating device working, the CURRENT temperature will be increasing and approach the same as the TARGET temperature:

1. In Figure 2, CURRENT(30°C) = TARGET(30°C)
2. The wireless thermostat sends commands to all the sockets to turn OFF CCRC30F-PLUG.
3. LCD display OFF symbol
4. The red LED indicator 7 is OFF
5. All the sockets remain OFF status until the temperature drops 1°C (TARGET - 1°C.) in this case the ON command is sent to all the sockets, turn ON the connected heating device once again.

* **So the room temperature will automatically remain:**
Target Temp. ≥ Room Temp. ≥ Target Temp. - 1°C

* **Thermostat control will detect temperature and transmit signal every 20 seconds, so there are some time delay in auto operation.**

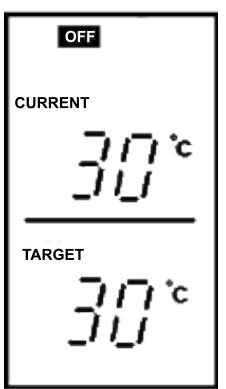

Fig.2

7. ALWAYS ON

Users can manually change the work mode to Always ON or Always OFF whatever the thermostat is in ON or OFF status:

Always ON Mode:

Hold and press 5 more than 3 seconds Wireless thermostat will be change to Always ON status, the connected heater will be always heating. And the Target temperature will be disappeared from the LCD, LCD part shows ON, all the connected socket is kept ON status, shows in Fig 3.

* It will be back to auto operation just by keep pressing 5 once again more than 3 seconds



Fig.3

8. ALWAYS OFF

Always OFF Mode:

Hold and press 6 more than 3 seconds. Wireless thermostat will be change to Always OFF status, the connected heater will be always OFF. And the Target temperature will be disappeared from the LCD, LCD part shows OFF, all the connected socket is kept OFF status, shows in Fig 4.

* It will be back to auto operation just by keep pressing 6 once again more than 3 seconds

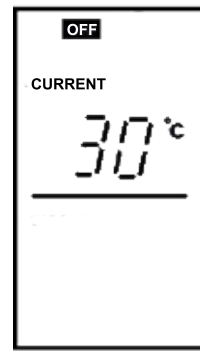

Fig.4

9. SPECIFICATION

CCWT450RCF, Remote thermostat control:

- CURRENT temp. range: 0°C~60°C or 32°F~140°F
- TARGET temp. range: 0°C~60°C or 32°F~140°F
- Temperature Resolution : ±1°C or ±1°F
- Each Press of LEFT/RIGHT Button: ±1°C or ±1°F
- 2pcs*1.5V AA battery
- Wall Mount Holder & Table Stand

CCRC30F-PLUG, Plug in Socket:

- Connection: 250 V ~ 50 Hz
- Transmission frequency: 433.92 MHz
- Maximum Rating: 3250W, 13 A
- Maximum range: 40 meters in open area
- EU, French, UK, Italy, Swiss, USA plug/socket optional